

# KIT JOHNSON

residential



Mount Haviland, Bath

£85,000

**One Bedroom Retirement Garden Apartment.**



2 Mount Haviland  
97 Lansdown Lane  
Bath  
BA1 4NB

**PRICE: £85,000**

A ground floor garden apartment within this popular development on Lansdown Road, just above Weston Village. For the over 60's, this is an ideal opportunity for those wanting an affordable home in Bath. The apartment has a fitted kitchen off to one side, living room with patio doors onto the gardens, bedroom, bathroom suite. If wanted, the owner has use of excellent communal facilities to include parking, reading room, guest room, social room, dining room, communal kitchen and Estate Manager. The village of Weston is just down the hill and on a regular bus route. Management Company; First Port 0333 3214041.

**Over 60's Development**

**Lovely Views**

**Kitchen Area**

**Living Room**

**Bedroom**

**Excellent Communal  
Facilities**

**New 125 Year Lease**

**Council Tax Band A £1101**

**Service Charge Circa £2637  
Per Annum**



FLOOR AREA 30 sq. m.  
( 322.92 sq. ft. )

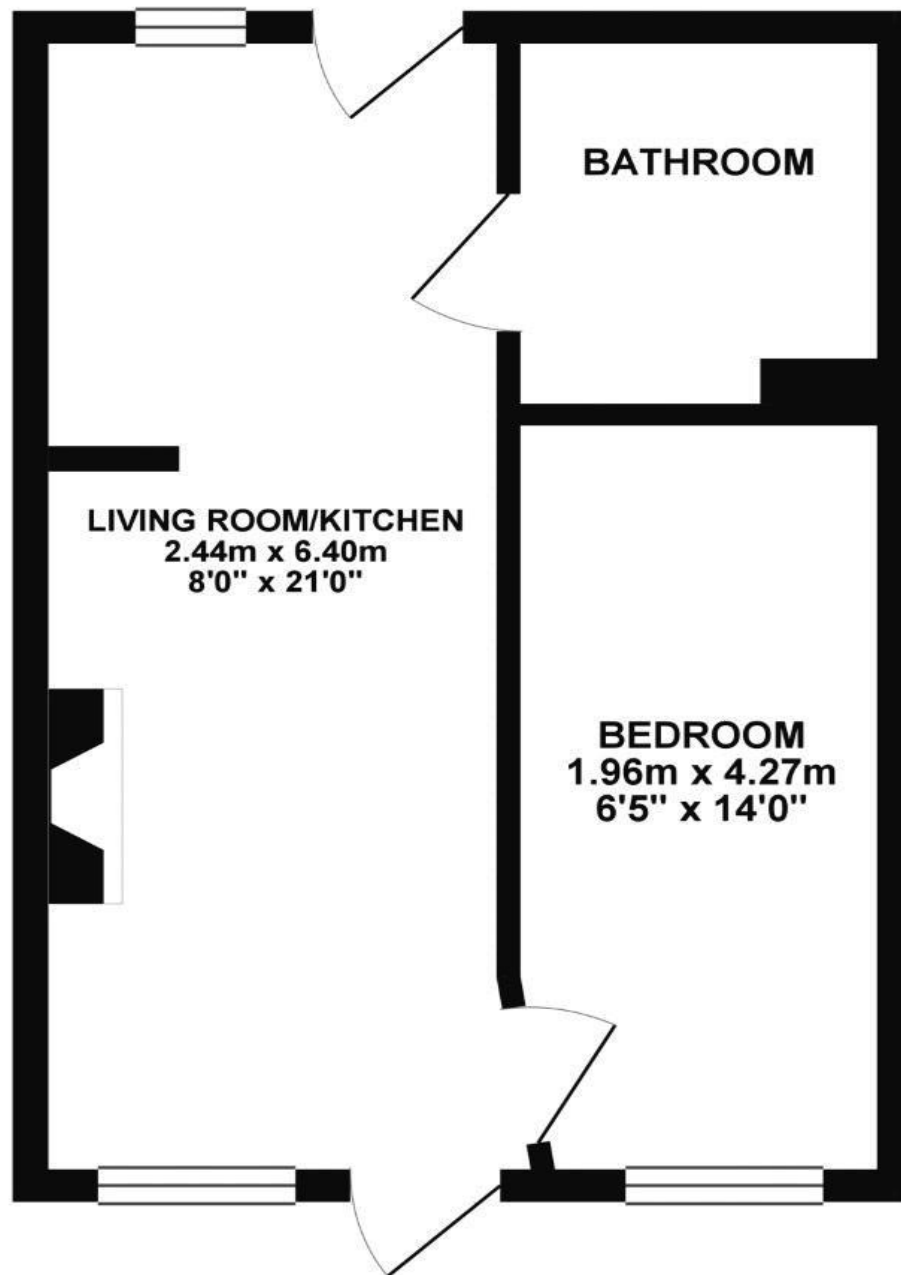

TOTAL FLOOR AREA : 30.00 sq. m. ( 322.92 sq. ft. ) approx.

Whilst every attempt has been made to ensure the accuracy of the floorplan contained here, measurements of doors, windows, rooms and any other items are approximate and no responsibility is taken for any error, omission or mis-statement. This plan is for illustrative purposes only and should be used as such by any prospective purchaser. The services, systems and appliances shown have not been tested and no guarantee as to their operability or efficiency can be given.  
Made with Metropix ©2019

**Kit Johnson Residential**  
**26-33 High St**  
**Weston**  
**Bath**  
**BA1 4BX**  
**01225 444447**  
**sales@kitjohnson.co.uk**  
**www.kitjohnson.co.uk**