

KIT JOHNSON

residential



Circa 2017. Three Bedroom Semi. EPC Grade B



16 Beckford Drive
Lansdown
Bath
BA1 9AU

PRICE: £400,000

Built by Linden Homes in 2017 and offered with vacant possession, a contemporary, stylish, three bedroom semi detached house on a popular new development on the Northern slopes of Bath. Hall, cloakroom, living room, open plan kitchen/dining room with integrated appliances and double glazed doors onto an enclosed landscaped garden. Three bedrooms, bathroom and ensuite shower room to the main bedroom. At the front there are two designated parking spaces for the property. The house is in the catchment area for Abbot Alphege Academy CofE Primary School. The bus link takes you into Bath City Centre in five minutes. Stunning countryside walks surround the development. Highly recommended.

2017 Construction (Linden Homes)

Popular Ensleigh Development

Three Bedrooms

Cloakroom, Bathroom & Ensuite

Living Room

Kitchen/Dining Room

Enclosed Garden

Parking For Two Cars

Gas Central Heating

Double Glazed Throughout

Freehold

Contemporary Garden

Excellent EPC Rating

996 Sq Ft (92.5 Sq Mt)

Council Tax Band D £1803

Vacant Possession



16 Beckford Drive

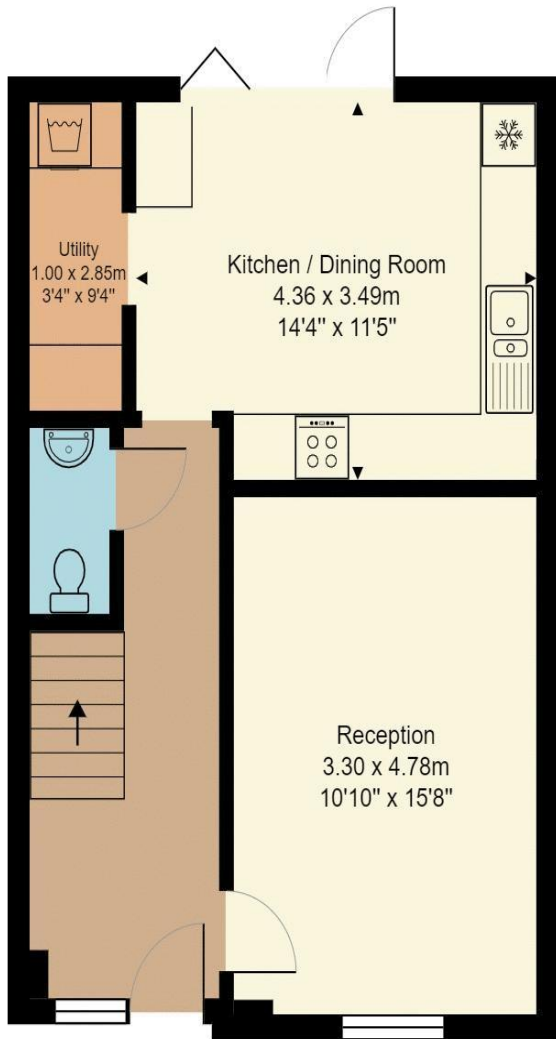

Ground Floor
Area: 46.3 m² ... 498 ft²

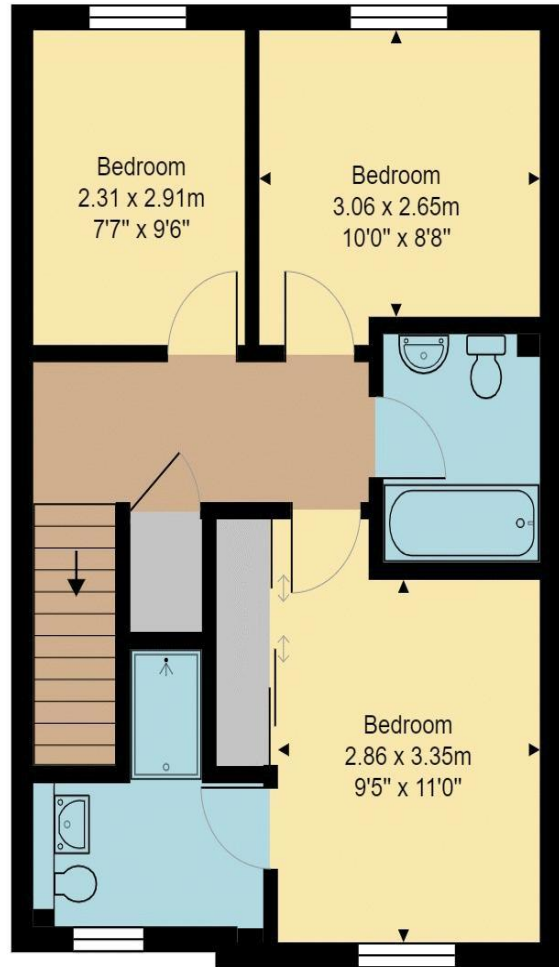

First Floor
Area: 46.3 m² ... 498 ft²

Total Area: 92.5 m² ... 996 ft²

All measurements of walls, doors, windows, fittings and appliances, their size and locations are approximate and cannot be regarded as being an accurate representation neither by the vendor nor their agent.
www.inovusproperty.co.uk



Kit Johnson Residential
26-33 High St
Weston
Bath
BA1 4BX
01225 444447
sales@kitjohnson.co.uk
www.kitjohnson.co.uk