

KIT JOHNSON

residential



Weston Park, Bath

£290,000

A Two Bedroom Ground Floor Apartment. Private South Facing Balcony. EPC Grade C



18 Hockley Court
Weston Park West
Bath
BA1 4AR

PRICE: £290,000

A light and spacious ground floor apartment in a tranquil, leafy setting in the Weston Park area of Bath and a level walk to the City Centre via Victoria Park. The property would be an ideal first purchase, investment or downsize. Communal entrance, private hall, living room with access to South facing balcony, modern fitted kitchen, two good bedrooms, excellent storage, and a bathroom with a window. Outside there are extensive communal gardens, parking and a single garage in a block. An exceptional opportunity.

Ground Floor Apartment
1970's Purpose Built Block
Private South Facing Balcony
Two Bedrooms
Modern Fitted Kitchen
Sitting Room
Bathroom Suite
Communal Gardens
Visitor Parking
Council Tax Band C £1681
Leasehold (999 Yrs Residue)
Managed by PPM South West Ltd (01395 262 796)
£1100 Per Annum Management Fees



18 Hockley Court, Bath

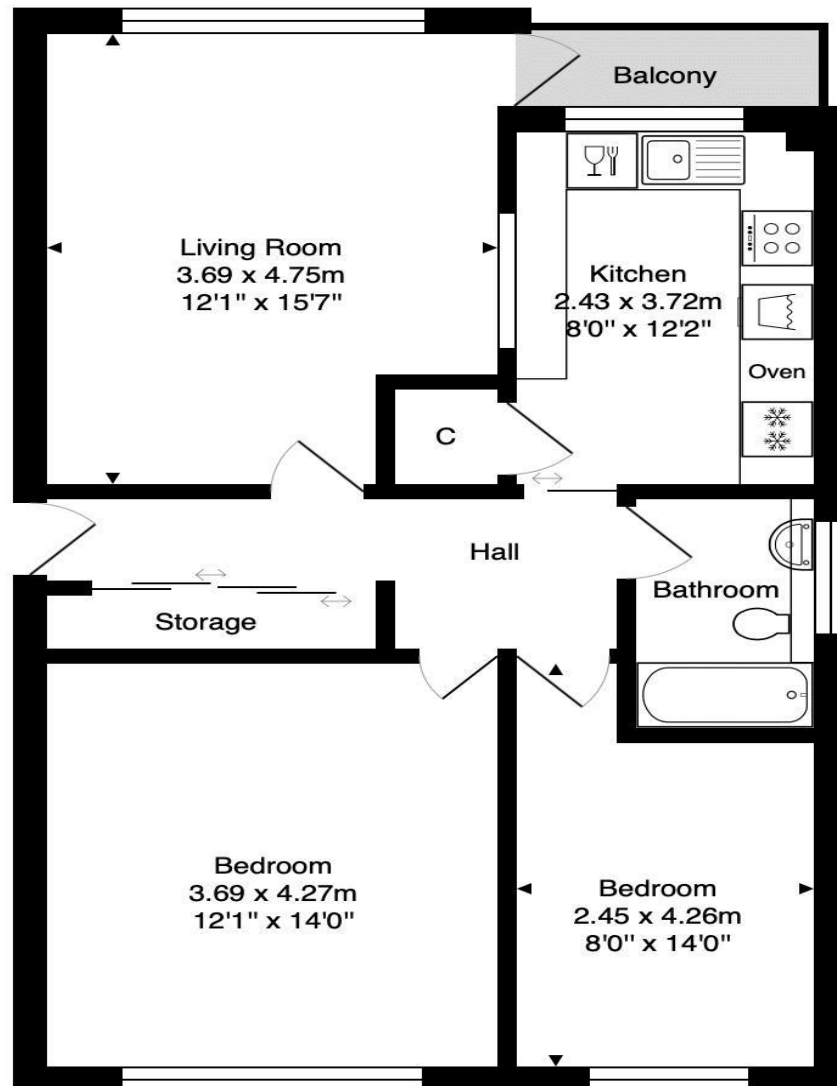

Total Area: 66.1 m² ... 711 ft² (excluding balcony)

Whilst every attempt has been made to ensure the accuracy of the floorplan contained here, measurements of doors, windows, rooms and any other items are approximate and no responsibility is taken for any error, omission or mis-statement.

This plan is purely for illustrative purposes only and should be used as such by any prospective purchaser.

Area includes internal and external wall thickness
www.energyassessmentservices.co.uk

Kit Johnson Residential
26-33 High St
Weston
Bath
BA1 4BX
01225 444447
sales@kitjohnson.co.uk
www.kitjohnson.co.uk